



6 Sawyer Hill

, Ballyclare, BT39 9WA

Offers over £114,950



6 Sawyer Hill

, Ballyclare, BT39 9WA

Offers over £114,950



Located in the heart of Ballyclare, Apartment 6 Sawyer Hill is a stylish and well-appointed third-floor residence offering modern living in a highly convenient setting. With an excellent range of local shops, cafés, parks and everyday amenities all within easy walking distance, the property is perfectly suited to those seeking both comfort and accessibility. Public transport links are readily available, providing straightforward connections to Belfast City Centre and surrounding towns.

Internally, the apartment is finished to a modern standard throughout and offers bright, well-proportioned accommodation. The layout comprises two spacious bedrooms, including a principal bedroom with ensuite, a contemporary main bathroom, and a generous open-plan kitchen, dining and living area—ideal for both relaxing and entertaining.

Further benefits include allocated parking and a low-maintenance lifestyle, making this an attractive option for first-time buyers, downsizers, or investors alike. Combining convenience, style, and practicality, Apartment 6 Sawyer Hill presents an excellent opportunity to secure a quality home in a central and sought-after location.

HALLWAY

5 x 10'10 (1.52m x 3.30m)

Hardwood front door. Access to storage. Access to roofspace.

STORAGE

4'2 x 2'11 (1.27m x 0.89m)

FITTED KITCHEN / LOUNGE

Range of high and low level units with contrasting worktops. 1.5 bowl sink unit with drainer and mixer

taps. Integrated electric oven and hob. Integrated extractor fan. Integrated fridge freezer. Tiled splashback. Tiled flooring in kitchen area.

BATHROOM

6'9 x 5'8 (2.06m x 1.73m)

White suite comprising paneled bath with mixer taps and overhead shower. Pedestal wash hand basin with mixer taps. Low flush W/C. Tiled flooring. Tiled splashback.

BEDROOM 1

13'4 x 9'11 (4.06m x 3.02m)

ENSUITE

5'2 x 6'10 (1.57m x 2.08m)

White suite comprising fully enclosed shower unit. Pedestal wash hand basin with mixer taps. Low flush W/C. Tiled flooring. Tiled splashback.

BEDROOM 2

12'7 x 9'5 (3.84m x 2.87m)

OUTSIDE

Allocated parking.

We endeavour to make our sales particulars accurate and reliable, however, they do not constitute or form part of an offer or any contract and none is to be relied upon as statements of representation or fact. Any services, systems and appliances listed in this specification have not been tested by us and no guarantee as to their operating ability or efficiency is given.

Do you need a mortgage to finance the property? Contact Smart Mortgages on 02893 438092.

Tel: 02893438090



Road Map



Hybrid Map



Terrain Map

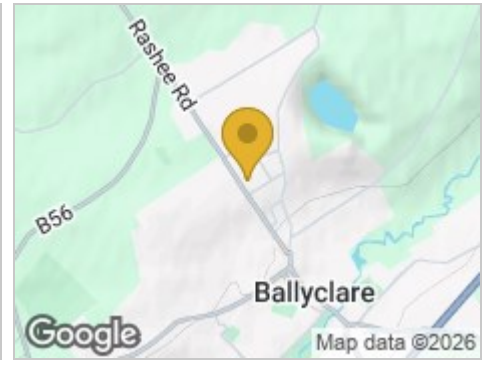

Floor Plan

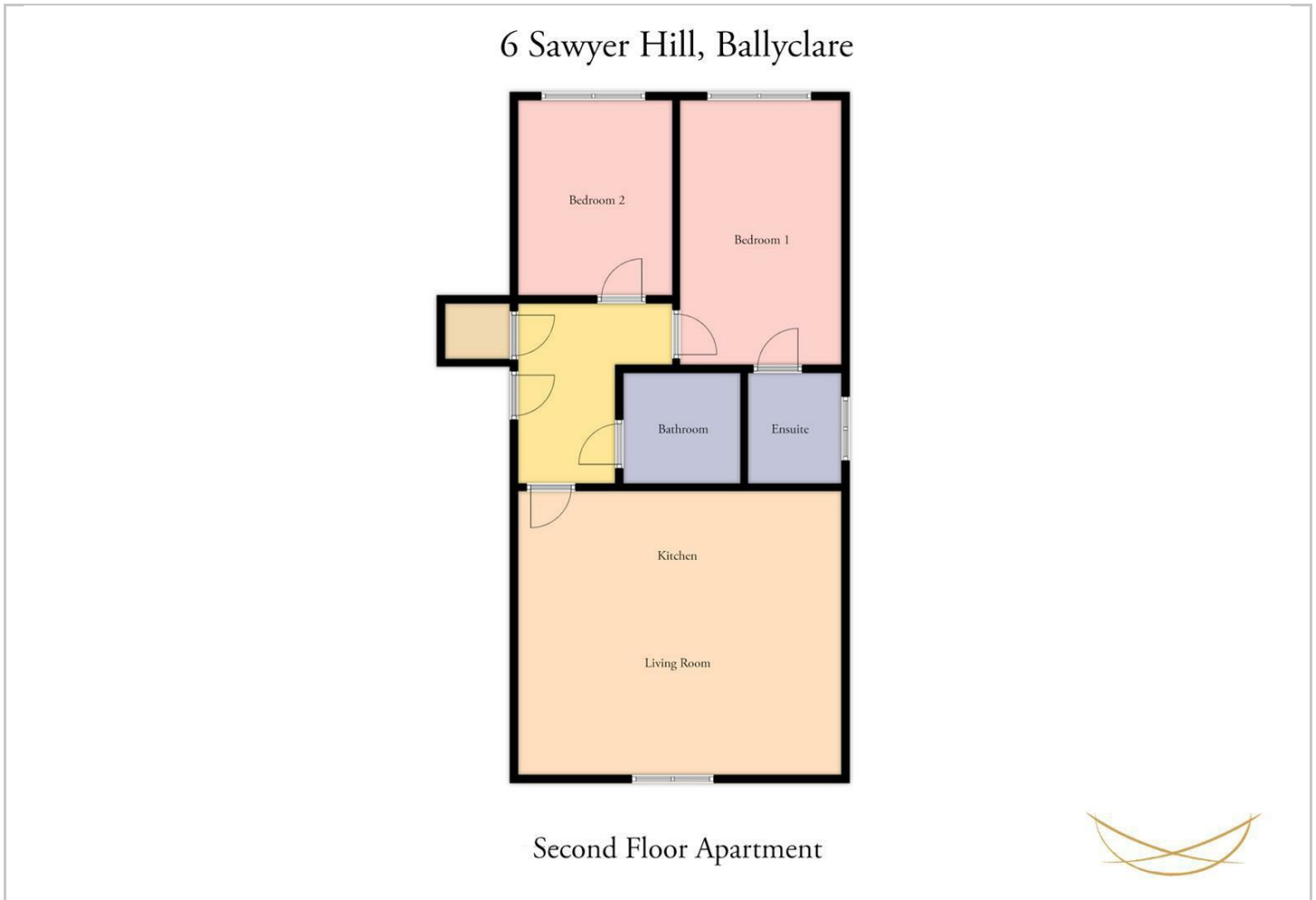

Viewing

Please contact our Nest Estate Agents Office on 02893438090 if you wish to arrange a viewing appointment for this property or require further information.

Energy Efficiency Graph

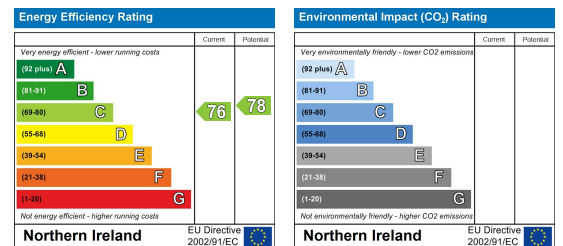

These particulars, whilst believed to be accurate are set out as a general outline only for guidance and do not constitute any part of an offer or contract. Intending purchasers should not rely on them as statements of representation of fact, but must satisfy themselves by inspection or otherwise as to their accuracy. No person in this firm's employment has the authority to make or give any representation or warranty in respect of the property.